

Série SC – Caps Retos

Especificações:

- Silicone Natural (600°F/316°C)
- EPDM Preto (425°F/218°C)

Características:

- Excelente vedação devido ao material flexível.
- Protege pontas e tubos em geral.
- Apesar de ser projetado como Cap, pode ser utilizado como plug se invertido.
- Silicone: excelente material que pode ser usado múltiplas vezes (devido a categoria alta temperatura).
- EPDM: material mais econômico com leve redução de resistência ao calor, mas resistência química superior. Também reutilizável.
- Aplicações: pintura a pó, pintura E, anodização, eletrodeposição e jateamento.

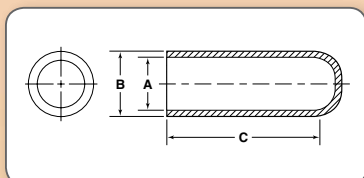

Código		Rosca Padrão		A		B		C		Embalagem
Silicone	EPDM	UNC	M	Pol	mm	Pol	mm	Pol	mm	
SC002005A	SC002005B	—	—	0.020	0.5	0.080	2.0	0.500	12.7	1000
SC003505A	SC003505B	—	—	0.035	0.9	0.095	2.4	0.500	12.7	1000
SC004007A	SC004007B	—	—	0.040	1.0	0.130	3.3	0.750	19.1	1000
SC006207A	SC006207C	—	—	0.062	1.6	0.152	3.9	0.750	19.1	1000
SC007010A	SC007010B	2-56	M2	0.070	1.8	0.160	4.1	1.000	25.4	1000
SC008007A	SC008007B	—	—	0.080	2.0	0.200	5.1	0.750	19.1	1000
SC009307A	SC009307B	3-48	—	0.093	2.4	0.193	4.9	0.750	19.1	1000
SC010005A	SC010005B	4-40	—	0.100	2.5	0.200	5.1	0.500	12.7	1000
SC010010A	SC010010C	4-40	—	0.100	2.5	0.200	5.1	1.000	25.4	1000
SC010907A	SC010907C	5-40	M3	0.109	2.8	0.209	5.3	0.750	19.1	1000
SC012510A	SC012510C	6-32	—	0.125	3.2	0.225	5.7	1.000	25.4	1000
SC014010A	SC014010C	—	—	0.140	3.6	0.260	6.6	1.000	25.4	1000
SC014810A	SC014810C	—	M4	0.148	3.8	0.248	6.3	1.000	25.4	1000
SC015605A	SC015605B	8-32	M4	0.156	4.0	0.276	7.0	0.500	12.7	1000
SC015610A	SC015610C	8-32	M4	0.156	4.0	0.276	7.0	1.000	25.4	1000
SC017205A	SC017205B	10-24	—	0.172	4.4	0.292	7.4	0.500	12.7	1000
SC017210A	SC017210B	—	—	0.172	4.4	0.292	7.4	1.000	25.4	1000
SC018010A	SC018010C	—	—	0.180	4.6	0.300	7.6	1.000	25.4	1000
SC018705A	SC018705B	12-24	M5	0.187	4.7	0.307	7.8	0.500	12.7	1000
SC018710A	SC018710B	12-24	M5	0.187	4.7	0.307	7.8	1.000	25.4	1000
SC018715A	SC018715B	12-24	M5	0.187	4.7	0.307	7.8	1.500	38.1	1000
SC019705A	SC019705B	—	—	0.197	5.0	0.317	8.1	0.500	12.7	1000
SC021810A	SC021810B	—	—	0.218	5.5	0.338	8.6	1.000	25.4	1000
SC022310A	SC022310B	—	M6	0.223	5.7	0.343	8.7	1.000	25.4	1000
SC022315A	SC022315B	—	M6	0.223	5.7	0.343	8.7	1.500	38.1	1000
SC023405A	SC023405B	1/4-20	—	0.234	5.9	0.354	9.0	0.500	12.7	1000
SC023410A	SC023410C	1/4-20	—	0.234	5.9	0.354	9.0	1.000	25.4	1000
SC02341125A	SC02341125B	1/4-20	—	0.234	5.9	0.354	9.0	1.125	28.6	1000
SC023415A	SC023415B	1/4-20	—	0.234	5.9	0.354	9.0	1.500	38.1	1000
SC025010A	SC025010C	—	—	0.250	6.3	0.370	9.4	1.000	25.4	1000

(Continua na página seguinte) ⇨



Série SC – Caps Retos (continuação)

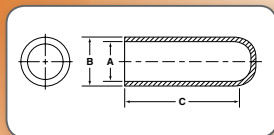

Código		Rosca Padrão		A		B		C		Embalagem
Silicone	EPDM	UNC	M	Pol	mm	Pol	mm	Pol	mm	
SC025015A	SC025015B	—	—	0.250	6.3	0.370	9.4	1.500	38.1	1000
SC028110A	SC028110B	5/16-18	—	0.281	7.1	0.401	10.2	1.000	25.4	1000
SC029505A	SC029505B	—	M8	0.295	7.5	0.415	10.5	0.500	12.7	1000
SC029510A	SC029510B	—	M8	0.295	7.5	0.415	10.5	1.000	25.4	1000
SC029515A	SC029515C	—	M8	0.295	7.5	0.415	10.5	1.500	38.1	1000
SC029517A	SC029517B	—	M8	0.295	7.5	0.415	10.5	1.750	44.5	1000
SC031210A	SC031210C	—	—	0.312	7.9	0.432	11.0	1.000	25.4	1000
SC031215A	SC031215B	—	—	0.312	7.9	0.432	11.0	1.500	38.1	1000
SC034010A	SC034010B	—	—	0.340	8.6	0.460	11.7	1.000	25.4	1000
SC035515A	SC035515B	3/8-14	—	0.355	9.0	0.475	12.1	1.500	38.1	1000
SC037510A	SC037510B	—	M10	0.375	9.5	0.495	12.6	1.000	25.4	1000
SC037515A	SC037515C	—	M10	0.375	9.5	0.495	12.6	1.500	38.1	500
SC040610A	SC040610B	7/16-14	—	0.406	10.3	0.526	13.4	1.000	25.4	200
SC043710A	SC043710B	—	—	0.437	11.1	0.557	14.2	1.000	25.4	200
SC045615A	SC045615B	—	M12	0.456	11.6	0.576	14.6	1.500	38.1	200
SC046810A	SC046810C	—	—	0.468	11.9	0.588	14.9	1.000	25.4	200
SC048015A	SC048015B	1/2-13	—	0.480	12.2	0.600	15.2	1.500	38.1	200
SC050015A	SC050015C	—	—	0.500	12.7	0.620	15.8	1.500	38.1	200
SC053115A	SC053115B	—	—	0.531	13.4	0.651	16.5	1.500	38.1	500
SC053515A	SC053515B	9/16-12	M14	0.535	13.6	0.655	16.6	1.500	38.1	200
SC056215A	SC056215B	—	M15	0.562	14.3	0.682	17.3	1.500	38.1	200
SC060015A	SC060015C	5/8-11	M16	0.600	15.2	0.720	18.3	1.500	38.1	100
SC062515A	SC062515B	—	M17	0.625	15.9	0.745	18.9	1.500	38.1	200
SC062525A	SC062525B	—	M17	0.625	15.9	0.745	18.9	2.500	63.5	200
SC068715A	SC068715B	—	—	0.687	17.4	0.807	20.5	1.500	38.1	200
SC073015A	SC073015B	3/4-10	M19	0.730	18.5	0.850	21.6	1.500	38.1	200
SC075015A	SC075015B	—	—	0.750	19.1	0.870	22.1	1.500	38.1	200
SC075035A	SC075035B	—	—	0.750	19.1	0.870	22.1	3.500	88.9	200
SC078015A	SC078015B	—	—	0.780	19.8	0.900	22.9	1.500	38.1	200
SC081215A	SC081215B	—	—	0.812	20.6	0.932	23.7	1.500	38.1	100
SC087515A	SC087515B	—	—	0.875	22.2	0.995	25.3	1.500	38.1	100
SC093715A	SC093715B	—	M24	0.937	23.8	1.057	26.9	1.500	38.1	100
SC097015A	SC097015B	1-8	M25	0.970	24.6	1.090	27.7	1.500	38.1	100
SC100015A	SC100015B	—	M27	1.000	25.4	1.120	28.5	1.500	38.1	100
SC106215A	SC106215B	—	—	1.062	26.0	1.182	30.0	1.500	38.1	100
SC106220A	SC106220B	—	—	1.062	26.0	1.182	30.0	2.000	50.8	100
SC112515A	SC112515B	—	M30	1.125	28.6	1.245	31.6	1.500	38.1	100
SC118715A	SC118715B	—	—	1.187	30.1	1.307	33.2	1.500	38.1	100
SC125015A	SC125015B	1 1/4 - 7	M33	1.250	31.8	1.370	34.8	1.500	38.1	100
SC135017A	SC135017B	—	—	1.350	34.3	1.470	37.3	1.750	44.4	100
SC150017A	SC150017B	1 1/4 - 7	M39	1.500	38.1	1.620	41.2	1.750	44.4	100
SC162520A	SC162520B	—	—	1.625	41.3	1.745	44.3	2.000	50.8	50
SC175020A	SC175020B	1 3/4 - 5	—	1.750	44.4	1.870	47.5	2.000	50.8	50
SC187520A	SC187520B	—	—	1.875	47.6	1.995	50.7	2.000	50.8	50
SC200020A	SC200020B	2 - 4 1/2	—	2.000	50.8	2.120	53.9	2.000	50.8	50